



# Close Coupled & Frame Mounted (CC&FM) Horizontal End Suction Pump

Document No: SP-ASY-004  
Revision: 21.1 (1/7/2021)

## Assembly Procedures

### ■ TO ASSEMBLE YOUR PUMP

1. Assemble mechanical seal, lubricate O-ring (54B) groove in floating seat (65A), and seat cavity in adapter (71) with molykote DC No.55 or synthetic lube. Install floating seat in adapter with lapped surface toward casing side of adapter.
2. Lubricate shaft sleeve (14) bore, and bore of rotating assembly (80A). Slide sleeve onto shaft (6).
3. **(Close Coupled)** Slide adapter (71) over the end of the motor shaft. Align the holes in the adapter with motor holes. Install adapter to motor bolts and tighten.  
**(Frame Mounted)** Slide adapter (71) over end of pump shaft (6). Align the holes in the adapter with bearing frame (19) holes. Install adapter to frame bolts and tighten.
4. Slide the rotating assembly (80A) onto the shaft sleeve. The lapped surface should be facing toward the stationary seat or motor end of the assembly. Install the spring (80B) – it is closest to the impeller.)
5. Install impeller key (32), making sure that the key goes into the notch on the shaft sleeve (14). Slide impeller (2) on, guiding the seal spring onto the impeller shoulder.
6. Tighten impeller screw (26), with impeller washer (24A) in place. Rotate assembly to ensure there is no binding and that assembly turns freely.

7. Install new casing gasket (73A). Slide casing (1) over impeller. Align adapter holes with casing holes to put discharge outlet in its proper orientation. Install adapter to casing bolts (170) and tighten. Check all drain plugs (35) to ensure all are in place and tight.
8. If close coupled, reinstall or take to spares storage.
9. If frame mounted, install coupling key (46) and tape in place. Reinstall or take to spares storage.

## Mechanical Seal Assembly

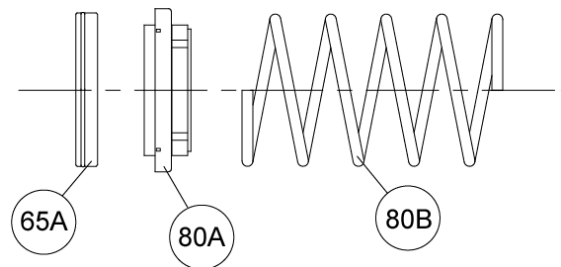

### Parts List

Item #	Description
65A	Stationary Seat
80A	Rotating Assembly
80B	Spring

© 2013 - 2021 SUMMIT PUMP, Inc

# CC and Frame Mounted Parts Assembly

## Cross Section

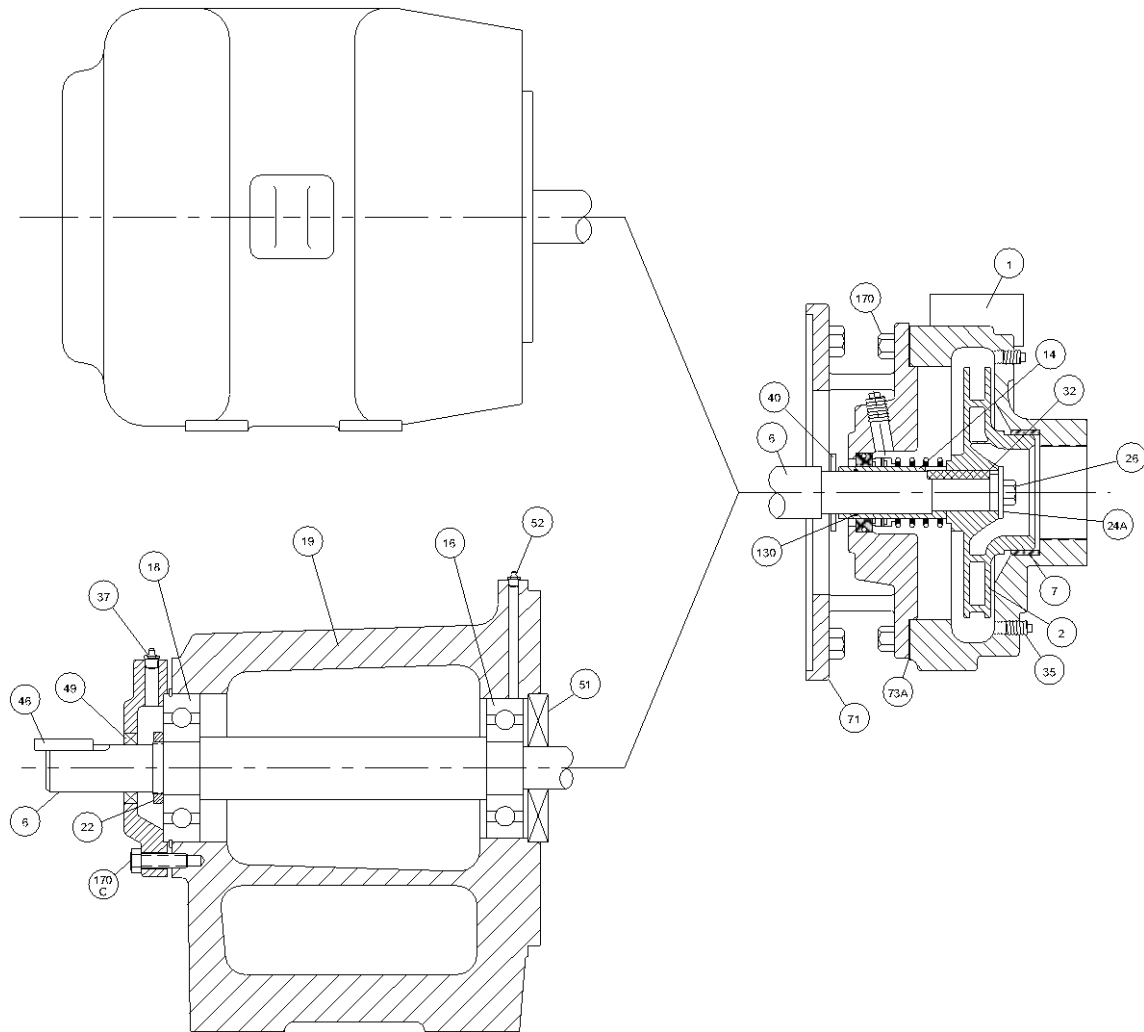

## Parts List

Item #	Description	Item #	Description
1	Casing	37	Bearing Cover, Outboard
2	Impeller	40	Deflector
6	Shaft	46	Key Coupling
7	Casing Ring (iron pumps only)	49	Bearing Cover Seal, Outboard
13	Packing	51	Grease Seal Inboard
14	Shaft Sleeve	52	Grease Fitting
16	Bearing, Inboard	53	Case Support (not shown)
18	Bearing, Outboard	65	Mechanical Seal, Stationary Element
19	Frame	71	Adapter
22	Lock Bearing Nut	73A	Casing Gasket
24A	Impeller Washer	80	Mechanical Seal, Rotating Element
26	Screw Impeller	130	Shaft Sleeve O-Ring
27	Adapter Ring	170	Bolt, Casing
32	Key Impeller	170B	Bolt, Frame to Adapter (not shown)
35	Plug Drain	170C	Bolt, Bearing Cap